



Miami-Dade County Public Schools

giving our students the world

Superintendent of Schools
Alberto M. Carvalho

Miami-Dade County School Board
Perla Tabares Hantman, Chair
Dr. Martin Karp, Vice Chair
Dr. Dorothy Bendross-Mindingall
Susie V. Castillo
Dr. Lawrence S. Feldman
Dr. Steve Gallon III
Lubby Navarro
Dr. Marta Pérez
Mari Tere Rojas

December 13, 2018

Dear Parents:

We want to inform you of changes that have been proposed for this school's attendance boundaries for the 2019-2020 school year. The students, who may be moved, live within the area(s) identified on the attached map.

To ensure that you, as parents, have all the information you need concerning these proposed recommendations, and to allow you to ask any questions you may have about these proposed changes, we have scheduled a special meeting to discuss this matter with you. This meeting will take place as follows:

Date: Friday, January 25, 2019
Time: 6:00 p.m.
Location: Bob Graham Education Center
15901 NW 79th Avenue Miami Lakes, FL 33016
Room: Elementary Cafeteria

The entire proposed boundary recommendation is posted on our website, <http://bgcc.dadeschools.net/>, and on the school's bulletin board.

If you have any other questions, please contact your school principal at (305) 557-3303.

Sincerely,



Jose Bueno, Region Superintendent

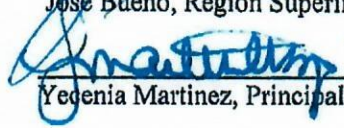

Yecenia Martinez, Principal

Map Attached

cc: Mrs. Valtena G. Brown
Mr. Steffond L. Cone
Mr. George A. Núñez



Miami-Dade County Public Schools

giving our students the world

Superintendent of Schools
Alberto M. Carvalho

Miami-Dade County School Board
Perla Tabares Hantman, Chair
Dr. Martin Karp, Vice Chair
Dr. Dorothy Bendross-Mindingall
Susie V. Castillo
Dr. Lawrence S. Feldman
Dr. Steve Gallon III
Lubby Navarro
Dr. Marta Pérez
Mari Tere Rojas

13 de diciembre del 2018

Estimados padres de familia:

Por este medio les notifico los cambios propuestos para las zonas de asistencia escolar de esta escuela para el curso escolar de 2019-2020. Los estudiantes a los que se pudiera trasladar, residen dentro de la/s área/s identificada(s) en el mapa adjunto.

A fin de garantizar que ustedes, como padres de familia, conozcan todos los detalles que necesitan saber en cuanto a dichas recomendaciones y darles la oportunidad de formular cualquier pregunta que pudieran tener en cuanto a los mismos, hemos programado una reunión especial para discutir este asunto con ustedes. La reunión se celebrará según se consigna a continuación:

Fecha: Viernes, 25 de enero del 2019
Horario: 6:00 p.m.
Lugar: Bob Graham Education Center
15901 NW 79th Avenue Miami Lakes, FL 3016
Aula: Elementary Cafeteria

La recomendación para los límites de la zona de asistencia escolar aparece en nuestro sitio "web", <http://bgec.dadeschools.net/> y en el tablero de anuncios de la escuela.

Si tienen otras preguntas, por favor, comuníquese con el/la director/a de la escuela llamando al (305) 557-3303.

Atentamente,



Jose Bueno, Superintendente de la Región



Yecenia Martinez, Directora

Mapa adjunto

cc: Sra. Valtena G. Brown
Sr. Steffond L. Cone
Sr. George A. Núñez

Barbara Goleman Senior
 14100 NW 89th Avenue
 Miami Lakes, Florida 33018

Hialeah Gardens Senior
 11700 Hialeah Gardens Blvd
 Hialeah Gardens, FL 33018

Hialeah Miami Lakes Senior
 7977 W 12th Ave
 Hialeah, FL 33014

American Senior
 18350 NW 67th Ave
 Hialeah, FL 33015

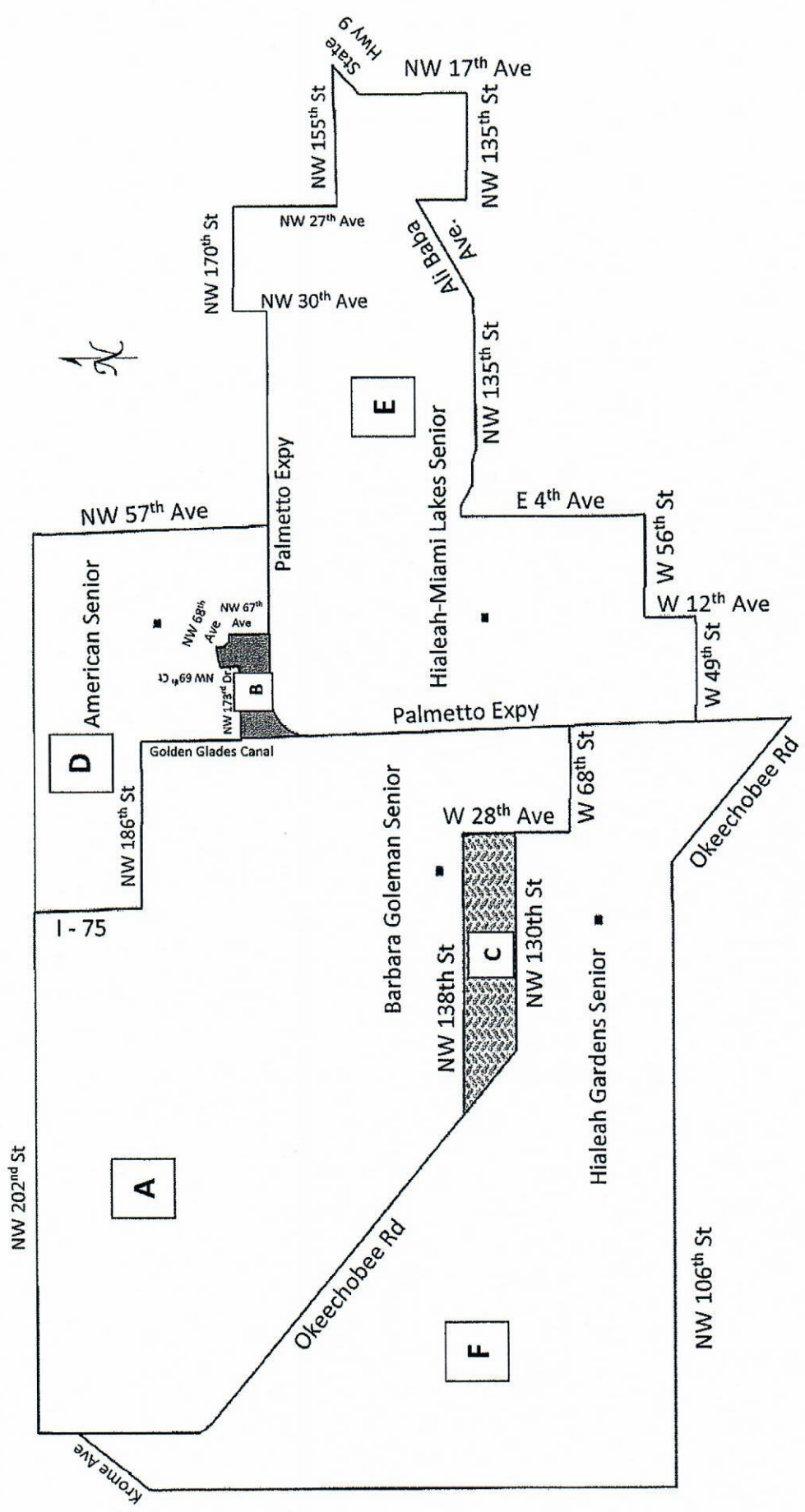

<p>Areas A, B and C represent the current boundary assigned to Barbara Goleman Senior High School.</p>	<p>A</p>	<p>B</p>	<p>C</p>
<p>Area D represents the current boundary assigned to American Senior High School. With the proposed changes, area D will include area B.</p>	<p>D</p>	<p>E</p>	<p>F</p>
<p>Area E represents the current boundary assigned to Hialeah-Miami Lakes Senior High School. With the proposed changes, area E will include area A.</p>	<p>E</p>	<p>F</p>	<p>Area F represents the current boundary assigned to Hialeah Gardens Senior High School. With the proposed changes, area F will include area C.</p>